

Diffuser - Type SRV

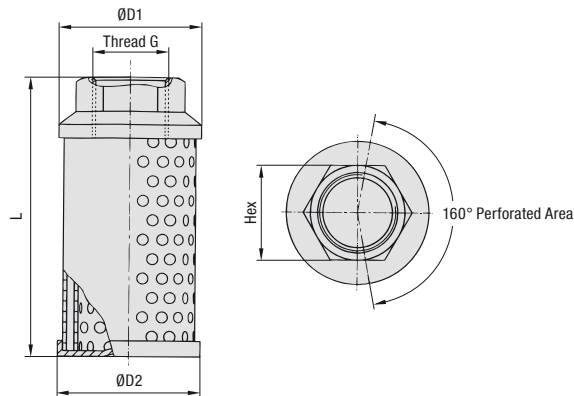

Installation

Installation below the minimum fluid level of the reservoir with the plain area facing the pump inlet

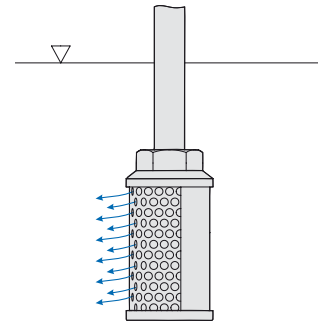

Characteristics

Designed for direct installation into return lines to reduce fluid aeration, foaming and noise; should always be installed below the minimum fluid level

Features

- Available with female BSP thread (ISO 228) or female NPT thread (ANSI B1.20.1)
- Operating temperature range: -20°C ... +100°C / -4°F ... +212°F
- Max. working pressure: 20 bar / 290 PSI

Media Compatibility

- Suitable for use with Mineral and Petroleum based hydraulic fluids (HL and HLP)

Construction and Materials

- 2 concentric tubes with inner spaced holes
- Threaded end cap made of Aluminium
- Other components made of Steel, zinc-plated

Special sizes, designs, materials and configurations are available on request. Consult STAUFF for details.



Diffusers SRV are ideally suited for use with STAUFF Return Line Filters of the RF series with threaded connection.

For details, please see Filtration Technology section from page C71 on.

Dimensions and Order Codes (Female BSP Threaded Version)

Order Code	Thread G	Dimensions (mm/in)				Max. Flow Rate
		ØD1	ØD2	L	Hex	
SRV - 050 - B12	G3/4	64	62	109	36	50 l/min
		2.52	2.44	4.29	1.42	13 US GPM
SRV - 114 - B16	G1	64	62	139	46	114 l/min
		2.52	2.44	5.47	1.81	30 US GPM
SRV - 200 - B20	G1-1/4	86	84	139	60	200 l/min
		3.39	3.31	5.47	2.36	52 US GPM
SRV - 227 - B24	G1-1/2	86	84	200	60	227 l/min
		3.39	3.31	7.87	2.36	59 US GPM
SRV - 454 - B32	G2	86	84	260	70	454 l/min
		3.39	3.31	10.24	2.76	118 US GPM
SRV - 650 - B40	G2-1/2	150	148	212	90	650 l/min
		5.91	5.83	8.35	3.54	169 US GPM
SRV - 950 - B48	G3	150	148	272	100	950 l/min
		5.91	5.83	10.71	3.94	247 US GPM

Dimensions and Order Codes (Female NPT Threaded Version)

Order Code	Thread G	Dimensions (mm/in)				Max. Flow Rate
		ØD1	ØD2	L	Hex	
SRV - 050 - N12	3/4 NPT	64	62	109	36	50 l/min
		2.52	2.44	4.29	1.42	13 US GPM
SRV - 114 - N16	1 NPT	64	62	139	46	114 l/min
		2.52	2.44	5.47	1.81	30 US GPM
SRV - 200 - N20	1-1/4 NPT	86	84	139	60	200 l/min
		3.39	3.31	5.47	2.36	52 US GPM
SRV - 227 - N24	1-1/2 NPT	86	84	200	60	227 l/min
		3.39	3.31	7.87	2.36	59 US GPM
SRV - 454 - N32	2 NPT	86	84	260	70	454 l/min
		3.39	3.31	10.24	2.76	118 US GPM
SRV - 650 - N40	2-1/2 NPT	150	148	212	90	650 l/min
		5.91	5.83	8.35	3.54	169 US GPM
SRV - 950 - N48	3 NPT	150	148	272	100	950 l/min
		5.91	5.83	10.71	3.94	247 US GPM