



# HYDRAULIC MEGASTORE

Serving the Hydraulics Industry Worldwide

## TC SERIES

### TIPPER COUPLINGS

#### INTRODUCTION

Holmbury Tipper Couplings use a screw thread connection. The female coupling has a wing nut sleeve which enables operators to connect the couplings by hand, even when there is low residual pressure in the line.

#### APPLICATIONS

Tipper Couplings are designed for use on mobile plant such as commercial vehicle trailers, agricultural equipment and construction plant.

#### MATERIALS

Zinc plated carbon steel body material with nitrile seals and PTFE backing ring.

#### TECHNICAL DETAILS

Maximum working pressure for both sizes is 250 bar. Working temperature range with nitrile seals is -20°C to +100°C

#### ACCESSORIES

##### PARKING STATIONS

Parking stations help avoid accidental damage and provide a storage location. **PLUGS**

Available for female couplings to prevent the ingress of dirt and avoid damage.

##### CAPS

Available for male couplings to prevent the ingress of dirt and avoid damage.



#### PRESSURE DROP CHARACTERISTICS

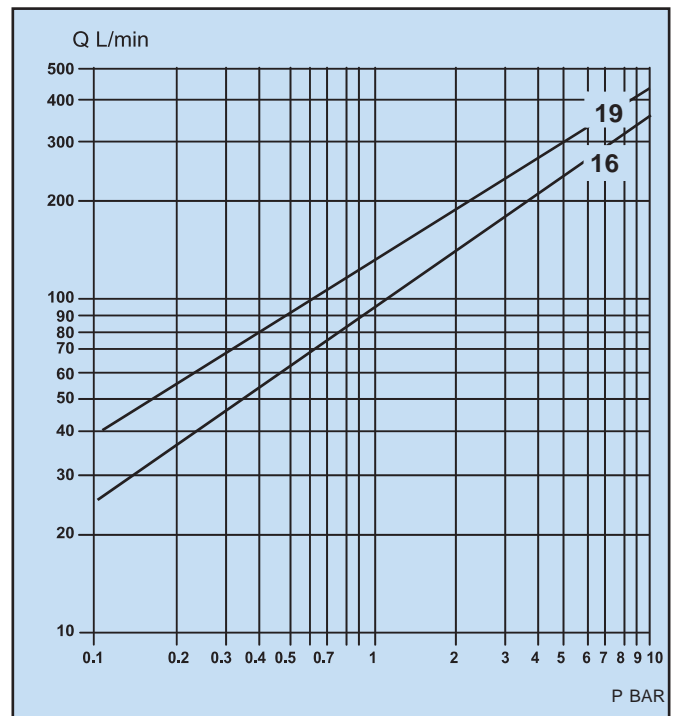

#### ORDER CODES

TC 16 - F - 12 G			
TC Series			
Coupling Size			Any other information
M = Male coupling			Blank = Nitrile Seals
F = Female coupling			
Thread size (dash system)			F = Female thread
12 = 3/4"			M = Male thread
16 = 1"			If blank then female thread is supplied.
Thread Form			
G = BSP P			

#### Example: TC16-F-12G

TC Series tipper coupling, size 16 female coupling, 3/4" BSP female thread, nitrile seals, no special requirements.

## TC SERIES, TIPPER COUPLINGS

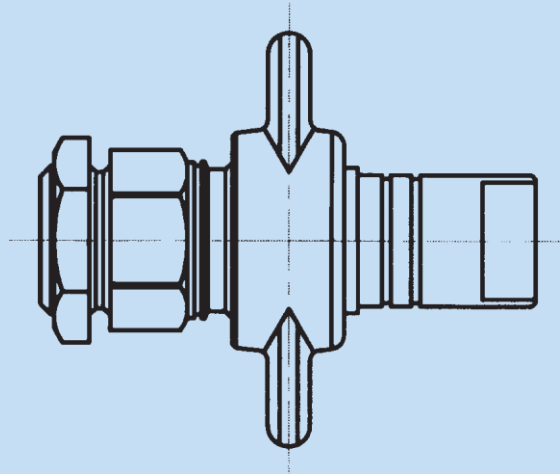

Female and Male Coupled

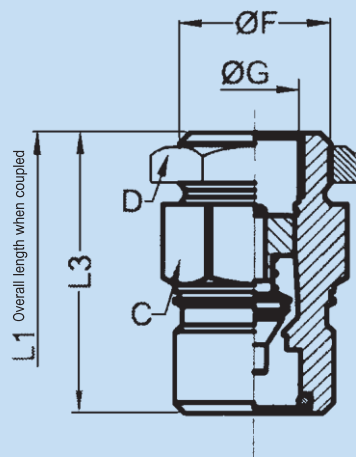

Male

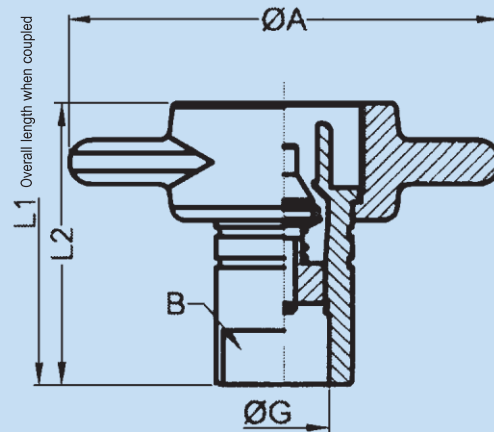

Female

### Male coupling

Size	ØG	C	D	L1	L3	ØF
TC 16 M 12	3/4" BSP	46	50	128.2	75.7	1 1/4"
TC 19 M 16	1" BSP	55	60	144.6	82.8	1 3/8"

### Female coupling

Size	ØG	B	L1	L2	ØA
TC 16 F 12	3/4" BSP	33	128.2	74.5	115
TC 19 F 16	1" BSP	40	144.6	82.8	115