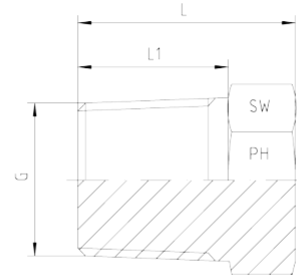
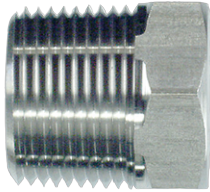

**Rubrik 5.17
BSP - Taper**

BSP - Taper

Pressure	Thread		Approx. Dimensions			Order-Code
	PN	G = BSPT	L	L1	SW	
400		1/8"-28	14	8	12	5070010-02
400		1/4"-19	18	12	14	5070010-04
400		3/8"-19	19	12	17	5070010-06
400		1/2"-14	27	19	22	5070010-08
400		3/4"-14	29	19	27	5070010-12
400		1"-11	29	18	36	5070010-16
200		1 1/4"-11	32	20	46	5070010-20
200		1 1/2"-11	36	22	50	5070010-24
100		2"-11	40	26	65	5070010-32