

GEWINDE-REDUZIERUNGEN



MALE/FEMALE STUD ADAPTORS

beide Gewinde: Whitworth-Rohrgewinde - zylindrisch -
DIN / ISO 228

Abdichtung durch Dichtkante Form B

Form: A

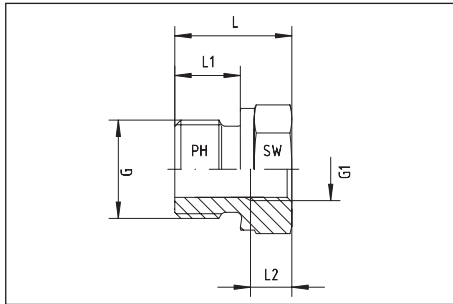

Form: B

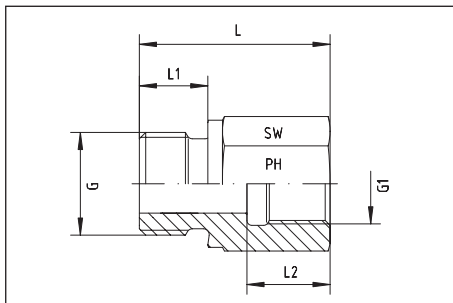

both threads: BSP - parallel -
DIN / ISO 228

Sealing by sealing shoulder form B

Form: A



Form: B



Druck Pressure PN	Außengewinde Male thread G	Innengewinde Female thread G1	ca. Maße approx. dimensions				Form Form	Bestellzeichen Order-Code
			L	L1	L2	SW		
630	G 1/8"	G 3/8"	32,0	8,0	17,0	24	B	GRI 1/8" x 3/8"
630	G 1/8"	G 1/4"	31,0	8,0	17,0	19	B	GRI 1/8" x 1/4"
630	G 1/4"	G 3/4"	43,0	12,0	22,0	36	B	GRI 1/4" x 3/4"
630	G 1/4"	G 1/2"	40,0	12,0	20,0	27	B	GRI 1/4" x 1/2"
630	G 1/4"	G 3/8"	36,0	12,0	17,0	24	B	GRI 1/4" x 3/8"
630	G 1/4"	G 1/8"	28,0	12,0	12,0	19	B	GRI 1/4" x 1/8"
400	G 3/8"	G 3/4"	44,0	12,0	22,0	36	B	GRI 3/8" x 3/4"
630	G 3/8"	G 1/2"	41,0	12,0	20,0	27	B	GRI 3/8" x 1/2"
630	G 3/8"	G 1/4"	36,0	12,0	17,0	22	B	GRI 3/8" x 1/4"
630	G 3/8"	G 1/8"	22,5	12,0	8,0	22	A	GRI 3/8" x 1/8"
250	G 1/2"	G 1 1/4"	53,0	14,0	26,5	55	B	GRI 1/2" x 1 1/4"
400	G 1/2"	G 1"	49,0	14,0	24,5	41	B	GRI 1/2" x 1"
400	G 1/2"	G 3/4"	46,0	14,0	22,0	36	B	GRI 1/2" x 3/4"
400	G 1/2"	G 3/8"	36,0	14,0	17,0	27	B	GRI 1/2" x 3/8"
400	G 1/2"	G 1/4"	24,0	14,0	12,0	27	A	GRI 1/2" x 1/4"
630	G 1/2"	G 1/8"	24,0	14,0	8,0	27	A	GRI 1/2" x 1/8"
250	G 3/4"	G 1 1/2"	57,0	16,0	28,5	60	B	GRI 3/4" x 1 1/2"
250	G 3/4"	G 1 1/4"	55,0	16,0	26,5	55	B	GRI 3/4" x 1 1/4"
400	G 3/4"	G 1"	51,0	16,0	24,5	41	B	GRI 3/4" x 1"
400	G 3/4"	G 1/2"	41,0	16,0	20,0	32	B	GRI 3/4" x 1/2"
400	G 3/4"	G 3/8"	26,0	16,0	13,0	32	A	GRI 3/4" x 3/8"
400	G 3/4"	G 1/4"	26,0	16,0	12,0	32	A	GRI 3/4" x 1/4"
400	G 3/4"	G 1/8"	26,0	16,0	8,0	32	A	GRI 3/4" x 1/8"
250	G 1"	G 1 1/2"	59,0	18,0	28,5	60	B	GRI 1" x 1 1/2"
250	G 1"	G 1 1/4"	57,0	18,0	26,5	55	B	GRI 1" x 1 1/4"
400	G 1"	G 3/4"	47,0	18,0	22,0	41	B	GRI 1" x 3/4"
400	G 1"	G 1/2"	29,0	18,0	14,0	41	A	GRI 1" x 1/2"
400	G 1"	G 3/8"	29,0	18,0	12,0	41	A	GRI 1" x 3/8"
400	G 1"	G 1/4"	29,0	18,0	12,0	41	A	GRI 1" x 1/4"
250	G 1 1/4"	G 1 1/2"	60,0	20,0	28,5	60	B	GRI 1 1/4" x 1 1/2"
250	G 1 1/4"	G 1"	52,0	20,0	24,5	50	B	GRI 1 1/4" x 1"
250	G 1 1/4"	G 3/4"	32,0	20,0	16,0	50	A	GRI 1 1/4" x 3/4"
250	G 1 1/4"	G 1/2"	32,0	20,0	14,0	60	A	GRI 1 1/4" x 1/2"
250	G 1 1/4"	G 3/8"	32,0	20,0	17,0	50	A	GRI 1 1/4" x 3/8"
250	G 1 1/2"	G 1 1/4"	58,0	22,0	26,5	55	B	GRI 1 1/2" x 1 1/4"
250	G 1 1/2"	G 1"	36,0	22,0	18,0	55	A	GRI 1 1/2" x 1"
250	G 1 1/2"	G 3/4"	36,0	22,0	16,0	55	A	GRI 1 1/2" x 3/4"
250	G 1 1/2"	G 1/2"	36,0	22,0	14,0	55	A	GRI 1 1/2" x 1/2"
250	G 2"	G 1 1/2"	42,0	22,5	18,5	70	A	GRI 2" x 1 1/2"
250	G 2"	G 1 1/4"	42,0	22,5	18,5	70	A	GRI 2" x 1 1/4"
250	G 2"	G 1"	42,0	22,5	18,5	70	A	GRI 2" x 1"
250	G 2"	G 3/4"	42,0	22,5	16,0	70	A	GRI 2" x 3/4"