

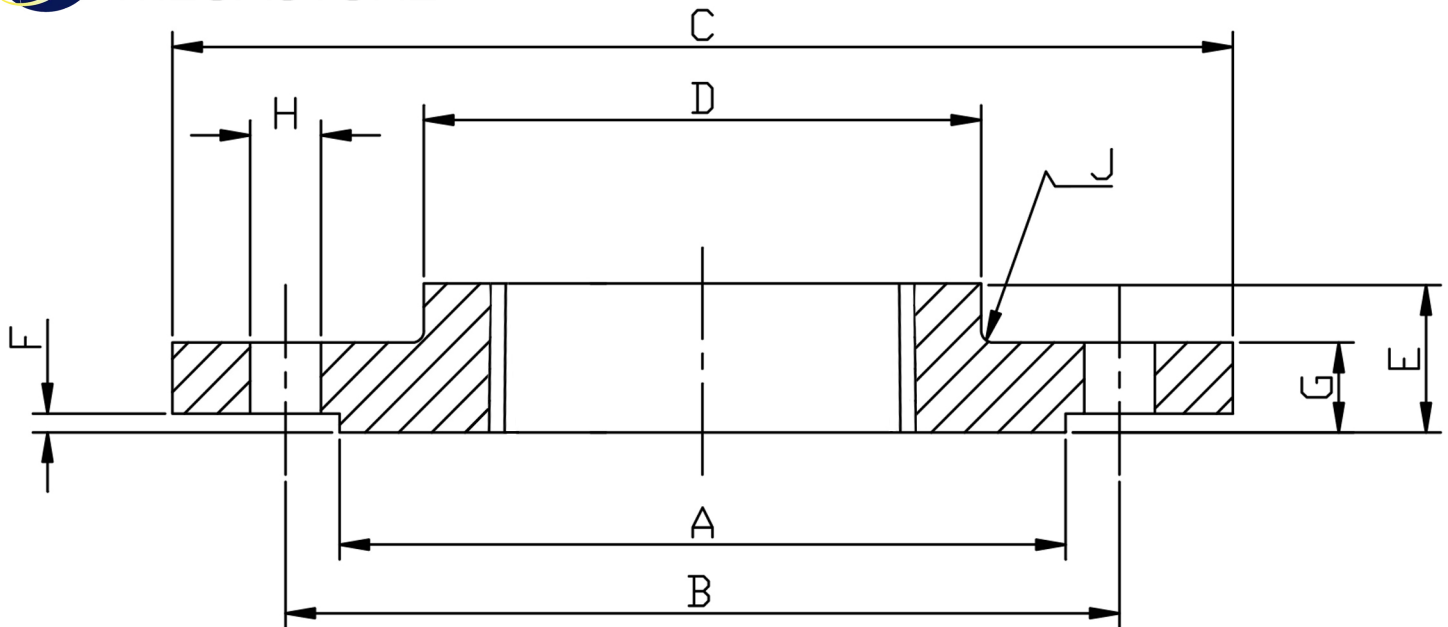

**HYDRAULIC
MEGASTORE**

| PIPE SIZE | DN | PART No | A | B | C | D | E | F | G | H | J | Kg EACH |
|-----------|-----|---------------|-------|-------|-------|-------|------|-----|------|--------|---|---------|
| 1/2 | 15 | F150SP0.5NPT | 34.9 | 60.3 | 88.9 | 30.2 | 15.9 | 1.6 | 11.1 | 4X15.9 | 3 | 0.4 |
| 3/4 | 20 | F150SP0.75NPT | 42.9 | 69.8 | 98.4 | 38.1 | 15.9 | 1.6 | 12.7 | 4X15.9 | 3 | 0.7 |
| 1 | 25 | F150SP1.0NPT | 50.8 | 79.4 | 107.9 | 49.2 | 17.5 | 1.6 | 14.3 | 4X15.9 | 3 | 0.9 |
| 1 1/4 | 32 | F150SP1.25NPT | 63.5 | 88.9 | 117.5 | 58.7 | 20.6 | 1.6 | 15.9 | 4X15.9 | 3 | 1.2 |
| 1 1/2 | 40 | F150SP1.5NPT | 73.0 | 98.4 | 127.0 | 65.1 | 22.2 | 1.6 | 17.5 | 4X15.9 | 3 | 1.5 |
| 2 | 50 | F150SP2.0NPT | 92.1 | 120.6 | 152.4 | 77.8 | 25.4 | 1.6 | 19.0 | 4X19.0 | 3 | 2.3 |
| 2 1/2 | 65 | F150SP2.5NPT | 104.8 | 139.7 | 177.8 | 90.5 | 28.6 | 1.6 | 22.2 | 4X19.0 | 3 | 3.7 |
| 3 | 80 | F150SP3.0NPT | 127.0 | 152.4 | 190.5 | 107.9 | 30.2 | 1.6 | 23.8 | 4X19.0 | 3 | 4.2 |
| 4 | 100 | F150SP4.0NPT | 157.2 | 190.5 | 228.6 | 134.9 | 33.3 | 1.6 | 23.8 | 8X19.0 | 3 | 5.9 |

*ASTM A182 316/L STAINLESS STEEL
 * TO ANSI/ASME B16.5
 *DIMENSIONS IN MM
 *WEIGHTS IN Kg EACH
 *THREADED NPT TO ANSI B2.1

****DIMENSIONS SUBJECT TO CHANGE, PLEASE CONTACT US IF CRITICAL****