

Equal Cross Type FI-K • Series LL / L / S

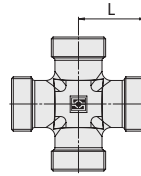
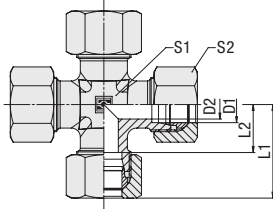

Series	Tube OD		PN		Dimensions					Weight (%/lbs) ca. per 100 ²	Ordering Codes ³	
	(mm/in)		(bar/PSI)		(mm/in)							
	D1				D2	L	L1 ¹	L2	S1	S2		
LL	4	100	3	15	21	11	9	10	1,68		FI-K-04LL-W3	
	.16	1450	.12	.59	.83	.43	.35	.39	3,69			
	6	100	4,5	15	21	9,5	9	12	1,76		FI-K-06LL-W3	
	.24	1450	.18	.59	.83	.37	.35	.47	3,87			
LL	8	100	6	17	23	11,5	12	14	2,85		FI-K-08LL-W3	
	.31	1450	.24	.67	.91	.45	.47	.55	6,27			
L	6	500	4	19	27	12	12	14	3,40		FI-K-06L-W3	
	.24	7250	.16	.75	1.06	.47	.47	.55	7,48			
	8	500	6	21	29	14	12	17	3,93		FI-K-08L-W3	
	.31	7250	.24	.83	1.14	.55	.47	.67	8,64			
	10	500	8	22	30	15	14	19	5,01		FI-K-10L-W3	
	.39	7250	.31	.87	1.18	.59	.55	.75	11,02			
	12	400	10	24	32	17	17	22	6,90		FI-K-12L-W3	
	.47	5800	.39	.94	1.26	.67	.67	.87	15,19			
	15	400	12	28	36	21	19	27	12,36		FI-K-15L-W3	
	.59	5800	.47	1.10	1.42	.83	.75	1.06	27,19			
	18	400	15	31	40	23,5	24	32	17,40		FI-K-18L-W3	
	.71	5800	.59	1.22	1.57	.93	.94	1.26	38,28			
	22	250	19	35	44	27,5	27	36	22,60		FI-K-22L-W3	
	.87	3625	.75	1.38	1.73	1.08	1.06	1.42	49,72			
	28	250	24	38	47	30,5	36	41	35,60		FI-K-28L-W3	
	1.10	3625	.94	1.50	1.85	1.20	1.42	1.61	78,32			
	35	250	30	45	56	34,5	41	50	54,67		FI-K-35L-W3	
	1.38	3625	1.18	1.77	2.20	1.36	1.61	1.97	120,27			
	42	250	36	51	63	40	50	60	92,70		FI-K-42L-W3	
	1.65	3625	1.42	2.01	2.48	1.57	1.97	2.36	209,30			
S	6	800	4	23	31	16	12	17	5,79		FI-K-06S-W3	
	.24	11600	.16	.91	1.22	.63	.47	.67	12,74			
	8	800	5	24	32	17	14	19	7,91		FI-K-08S-W3	
	.31	11600	.20	.94	1.26	.67	.55	.75	17,41			
	10	800	7	25	34	17,5	17	22	10,13		FI-K-10S-W3	
	.39	11600	.28	.98	1.34	.69	.67	.87	22,28			
	12	630	8	29	38	21,5	17	24	13,59		FI-K-12S-W3	
	.47	9135	.31	1.14	1.50	.85	.67	.94	29,90			
	14	630	10	30	40	22	19	27	16,21		FI-K-14S-W3	
	.55	9135	.39	1.18	1.57	.87	.75	1.06	35,65			
	16	630	12	33	43	24,5	24	30	22,15		FI-K-16S-W3	
	.63	9135	.47	1.30	1.69	.96	.94	1.18	48,73			
	20	400	16	37	48	26,5	27	36	31,07		FI-K-20S-W3	
	.79	5800	.63	1.46	1.89	1.04	1.06	1.42	68,35			
	25	400	20	42	54	30	36	46	53,00		FI-K-25S-W3	
	.98	5800	.79	1.65	2.13	1.18	1.42	1.81	116,60			
30	400	25	49	62	35,5	41	50	84,30		FI-K-30S-W3		
1.18	5800	.98	1.93	2.44	1.40	1.61	1.97	185,46				
38	400	32	57	72	41	50	60	135,10		FI-K-38S-W3		
1.50	5800	1.26	2.24	2.83	1.61	1.97	2.36	297,22				

Ordering Codes

***FI-K*-10*L*-W3*-MS**

* Equal Cross		FI-K
* Outside Tube Diameter D1 (in mm)		-10
* Series	Extra-Light Series	LL
	Light Series	L
	Heavy Series	S
* Material Code	Steel, zinc/nickel-plated	-W3
Please contact STAUFF for alternative materials and surface finishings.		
* Assembling / Kitting	Fitting body only	—
	Fitting body supplied with cutting rings and union nuts	-MS
	Fitting body supplied with soft-sealing cutting rings and union nuts	-MSV

Connecting Parts

	Cutting Ring Type FI-DS	Page 26
	Soft-Sealing Cutting Ring Type FI-WDDS	Page 27
	Support Sleeve Type FI-VH	Page 28
	STAUFF Form Ring Type FI-AR	Page 30
	Union Nut Type FI-M	Page 31
	37° Flared Tube Fitting Set Type FI-AB	Page 35

¹ Approximate dimension in assembled condition.

² Weight excluding cutting rings and union nuts.

³ Standard scope of delivery: Fitting body only.