

# HMT HYDRAULIC CYLINDERS

DOUBLE / SINGLE\* ACTING HYDRAULIC CYLINDER (\*=S/A WITH USE OF A BREATHER)

MAX PRESSURE = 210 BAR (CONTINUOUS) ► 250 BAR (INTERMITTENT)

MAX SPEED = 0.5 M/S

OPERATING TEMPERATURE (°C) = +80°C ► -25°C

TUBE MATERIAL = STEEL - ST52.3 - DIN2393 - ISO H9

ROD MATERIAL = STEEL - UNI C45 (SAE 1045) - 25 MICRON (±5) - EN8 GRADE

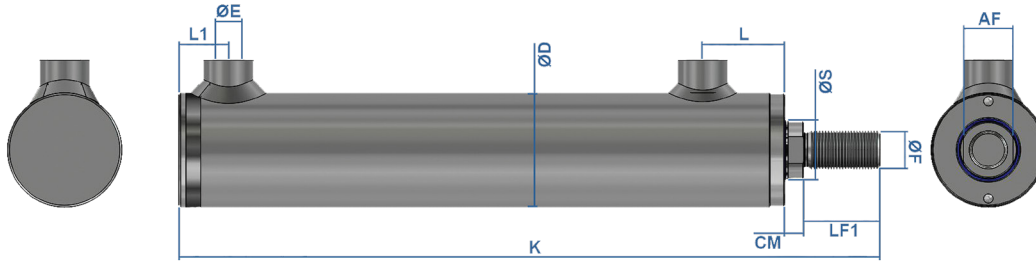
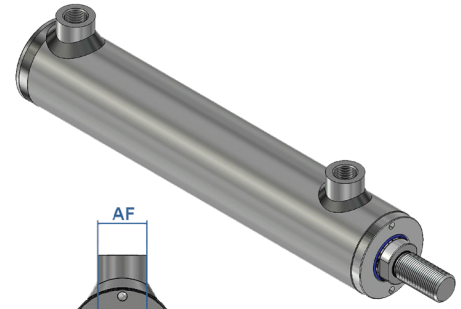

ORDER CODE	BORE Ø(mm)	D Ø(mm)	S Ø(mm)	K (mm)	STROKE (mm)	E Ø(bsp)	CM (mm)	L (mm)	L1 (mm)	F Ø(mm)	LF1 (mm)	AF (mm)	WEIGHT (kgs)
HMT1200100	40	50	20	248	100	1/4"	10	40	23	16 x 1.5	30	18	2.4
HMT1200200				348	200								3.2
HMT1200300				448	300								4.0
HMT1200400				548	400								4.8
HMT1200500				648	500								5.6
HMT2300100	50	60	30	268	100	3/8"	10	43	26	20 x 1.5	40	26	3.5
HMT2300200				368	200								4.8
HMT2300300				468	300								6.1
HMT2300400				568	400								7.3
HMT2300500				668	500								8.6
HMT3350100	60	70	35	297	100	3/8"	10	50	30	27 x 2	50	32	5.2
HMT3350200				397	200								6.8
HMT3350300				497	300								8.3
HMT3350400				597	400								10.0
HMT3350500				697	500								11.4
HMT3400100	60	70	40	309	100	3/8"	12	50	30	30 x 2	60	36	6.5
HMT3400200				409	200								7.5
HMT3400300				509	300								9.2
HMT3400400				609	400								11.0
HMT3400500				709	500								13.4
HMT063350200	63	73	35	397	200	3/8"	10	50	30	27 x 2	50	32	6.7
HMT063350300				497	300								8.5
HMT063350400				597	400								10.2
HMT063350500				697	500								12.4
HMT4350100	70	80	35	297	100	3/8"	10	50	33	27 x 2	50	32	6.2
HMT4350200				397	200								7.8
HMT4350300				497	300								9.5
HMT4350400				597	400								13.0
HMT4350500				697	500								14.4
HMT4400100	70	80	40	309	100	3/8"	12	50	33	30 x 2	60	36	7.7
HMT4400200				409	200								8.3
HMT4400300				509	300								10.4
HMT4400400				609	400								13.0
HMT4400500				709	500								14.3
HMT5500200	80	90	50	440	200	1/2"	15	60	35	36 x 2	70	45	12.5
HMT5500300				540	300								15.3
HMT5500400				640	400								18.2
HMT5500500				740	500								21.0
HMT6500200	100	115	50	470	200	1/2"	15	82	38	36 x 2	70	45	19.9
HMT6500300				570	300								23.3
HMT6500400				670	400								26.8
HMT6500500				770	500								30.2