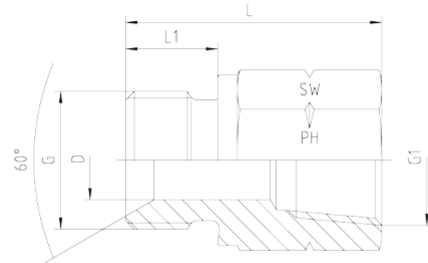
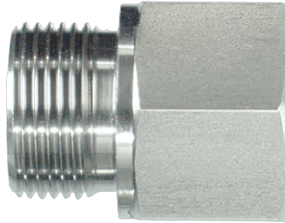

**Rubrik 5.50
BSP - Male - NPT - Female - Form B**

BSP - Male with 60°-Cone
NPT - Female

Pressure	Thread		Approx. Dimensions				Form	Order-Code	
	PN	G = BSP	G1 = NPT	L	L1	D			SW
400		1/8"-28	1/8"-27	25,0	8	4	14	B	1050518-02-02
400		1/8"-28	1/4"-18	31,0	8	4	19	B	1050518-02-04
400		1/4"-19	1/8"-27	32,0	12	6	19	B	1050518-04-02
400		1/4"-19	1/4"-18	32,0	12	6	19	B	1050518-04-04
400		1/4"-19	3/8"-18	31,0	10	7	24	B	1050518-04-06
400		1/4"-19	1/2"-14	38,0	10	7	27	B	1050518-04-08
400		3/8"-19	1/4"-18	36,0	12	9	22	B	1050518-06-04
400		3/8"-19	3/8"-18	36,0	12	9	24	B	1050518-06-06
400		3/8"-19	1/2"-14	37,0	12	9	27	B	1050518-06-08
400		1/2"-14	1/2"-14	39,0	14	12	27	B	1050518-08-08
400		1/2"-14	3/4"-14	46,0	14	13	36	B	1050518-08-12
400		3/4"-14	1/2"-14	44,0	16	18	32	A	1050518-12-08
400		3/4"-14	3/4"-14	48,0	16	18	36	B	1050518-12-12
400		3/4"-14	1"-11,5	51,0	16	18	41	B	1050518-12-16
400		1"-11	1"-11,5	49,5	18	22	41	B	1050518-16-16
400		1"-11	1 1/4"-11,5	50,5	18	22	50	B	1050518-16-20
200		1 1/4"-11	1 1/4"-11,5	58,0	20	25	50	B	1050518-20-20
200		1 1/2"-11	1 1/2"-11,5	62,0	22	37	55	B	1050518-24-24
100		2"-11	2"-11,5	64,0	23	43	70	B	1050518-32-32