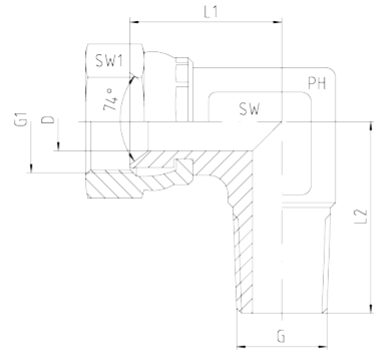
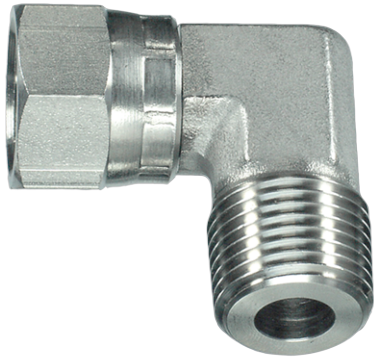

**Rubrik 6.28
JIC - Female x NPT - Male**

**90°-Swivel-Male-Elbow
JIC - Female - Swivel
NPT - Male**

Pressure	Tube O.D.		Thread		Approx. Dimensions					Order-Code	
	PN	mm	in.	G1 = UNF/UN	G = NPT	L1	L2	D	SW1		SW
350	6	1/4"		7/16"-20	1/8"-27	18,5	20,0	4,5	17	12	1252519-04-02
350	6	1/4"		7/16"-20	1/4"-18	18,5	25,0	4,5	17	14	1252519-04-04
350	6	1/4"		7/16"-20	3/8"-18				17		1252519-04-06
350	8	5/16"		1/2"-20	1/8"-27				17		1252519-05-02
350	8	5/16"		1/2"-20	1/4"-18	18,5	25,0	6,0	17	14	1252519-05-04
350	8	5/16"		1/2"-20	3/8"-18				17		1252519-05-06
350	10	3/8"		9/16"-18	1/4"-18	22,3	25,0	7,5	19	14	1252519-06-04
350	10	3/8"		9/16"-18	3/8"-18	22,3	27,0	7,5	19	14	1252519-06-06
350	10	3/8"		9/16"-18	1/2"-14				19		1252519-06-08
350	12	1/2"		3/4"-16	1/4"-18	24,5	29,5	10,0	24	19	1252519-08-04
350	12	1/2"		3/4"-16	3/8"-18	24,5	29,5	10,0	24	19	1252519-08-06
350	12	1/2"		3/4"-16	1/2"-14	24,5	34,0	10,0	24		1252519-08-08
280	12	1/2"		3/4"-16	3/4"-14				24		1252519-08-12
350	14, 15, 16	5/8"		7/8"-14	3/8"-18	29,5	37,0	12,0	27	24	1252519-10-06
350	14, 15, 16	5/8"		7/8"-14	1/2"-14	29,5	38,0	12,0	27	24	1252519-10-08
280	14, 15, 16	5/8"		7/8"-14	3/4"-14	29,5	41,5	12,0	27	24	1252519-10-12
280	18,20	3/4"		1 1/16"-12	1/2"-14	31,0	38,0	15,5	32	24	1252519-12-08
280	18,20	3/4"		1 1/16"-12	3/4"-14	31,0	41,5	15,5	32	24	1252519-12-12
280	18,20	3/4"		1 1/16"-12	1"-11,5				32		1252519-12-16
280	25	1"		1 5/16"-12	3/4"-14	37,0	46,0	21,0	41	33	1252519-16-12
280	25	1"		1 5/16"-12	1"-11,5				41	33	1252519-16-16
210	25	1"		1 5/16"-12	1 1/4"-11,5				41		1252519-16-20
210	28, 30, 32	1 1/4"		1 5/8"-12	1"-11,5				50		1252519-20-16
210	28, 30, 32	1 1/4"		1 5/8"-12	1 1/4"-11,5				50		1252519-20-20
210	28, 30, 32	1 1/4"		1 5/8"-12	1 1/2"-11,5				50		1252519-20-24
210	35, 38	1 1/2"		1 7/8"-12	1 1/4"-11,5				55		1252519-24-20
210	35, 38	1 1/2"		1 7/8"-12	1 1/2"-11,5	47,2	63,0	33,0	55	50	1252519-24-24