

Type ASA33

Series of coils conforming to DIN 43650 standards, insulation class F.

They can be mounted on the following valves: AE..22, from 1/4" to 1".

For the connectors type A122... see page 2.210.20.



| Voltage | | Code | Item |
|---------|----|--------|------------|
| 12V | DC | 034311 | ASA3301200 |
| 12V | AC | 034312 | ASA3301250 |
| 24V | DC | 034313 | ASA3302400 |
| 24V | AC | 034314 | ASA3302450 |
| 48V | AC | 034315 | ASA3304850 |
| 110V | AC | 034316 | ASA3311050 |
| 230V | AC | 034317 | ASA3323050 |

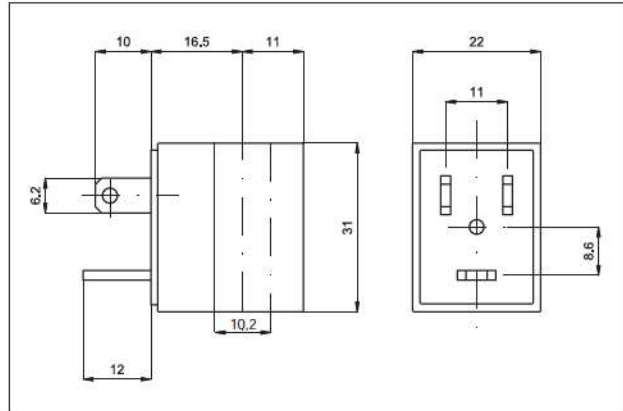

| Technical data | Direct current | Alternating current |
|------------------------|--|-----------------------------------|
| Voltage tolerance | ± 10% | - 10% ÷ +15% |
| Frequency tolerance | - | ± 5% |
| Electrical consumption | 6,5 W | 8 VA |
| Voltage | 12 and 24 V | 12, 24, 48, 110, 230 V 50/60HZ |
| Duty cycle | 100% ED | |
| Class protection | IP 65 (with connector already mounted) | |
| Temperature range | -10 °C ÷ + 55 °C | |
| Response time | 10 ms | |

Type ASA32

Series of coils conforming to DIN 43650/A standards, insulation class F.

They can be mounted on the following valves: AE..22, 1 1/4", 1 1/2", 2".

For the connectors type A182... see page 2.210.30.



| Voltage | | Code | Item |
|---------|----|--------|------------|
| 12V | DC | 034321 | ASA3201200 |
| 12V | AC | 034322 | ASA3201250 |
| 24V | DC | 034323 | ASA3202400 |
| 24V | AC | 034324 | ASA3202450 |
| 48V | AC | 034325 | ASA3204850 |
| 110V | AC | 034326 | ASA3211050 |
| 230V | AC | 034327 | ASA3223050 |

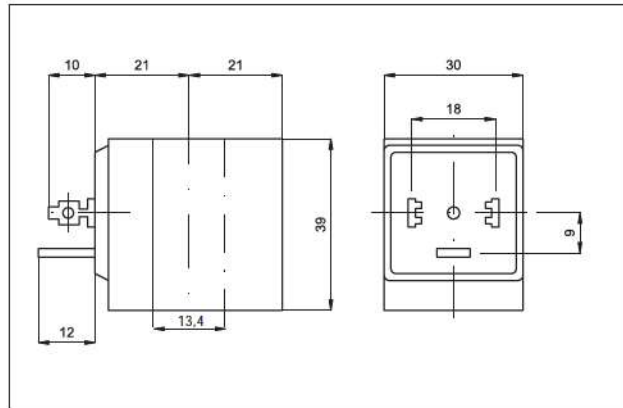

| Technical data | Direct current | Alternating current |
|------------------------|--|-----------------------------------|
| Voltage tolerance | ± 10% | - 10% ÷ +15% |
| Frequency tolerance | - | ± 5% |
| Electrical consumption | 10 W | 15 VA |
| Voltage | 12 and 24 V | 12, 24, 48, 110, 230 V 50/60HZ |
| Duty cycle | 100% ED | |
| Class protection | IP 65 (with connector already mounted) | |
| Temperature range | -10 °C ÷ + 55 °C | |
| Response time | 10 ms | |