

Hydraulic valves

Hydraulic valves with electric drive

Coils

Page: 1/1

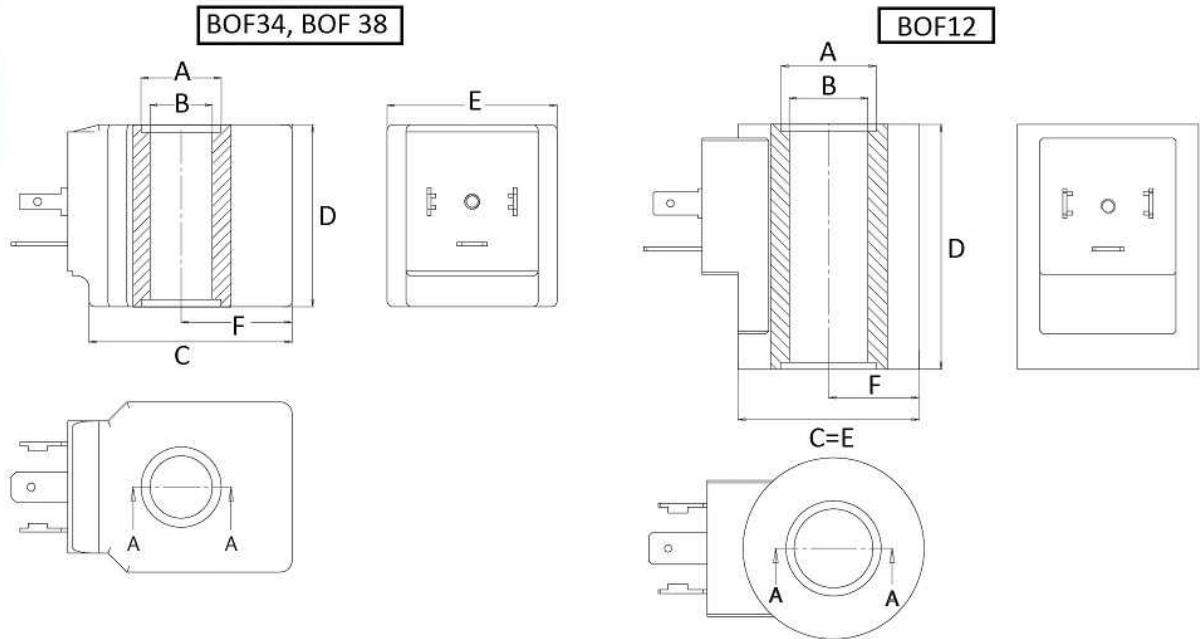

Coil with connector type DIN 43650
100% ED

Part n°	Size	Voltage (V)	Power (W)	P(IP)	ØA	ØB	C	D	E	F
BOF3812CC	SAE 08	12 VDC	22	IP 65	17	13,2	43	38,6	36	23,5
BOF3824CC	SAE 08	24 VDC	22	IP 65	17	13,2	43	38,6	36	23,5
BOF38220CC	SAE 08	220 VRAC	22	IP 65	17	13,2	43	38,6	36	23,5
BOF1212CC	SAE 10	12 VDC	26	IP 65	19,5	16,15	37,15	50	37,15	18,6
BOF1224CC	SAE 10	24 VDC	26	IP 65	19,5	16,15	37,15	50	37,15	18,6
BOF12220CC	SAE 10	220 VRAC	26	IP 65	19,5	16,15	37,15	50	37,15	18,6
BOF3412CC	SAE 12	12 VDC	22	IP 65	17	13,2	43	38,6	36	23,5
BOF3424CC	SAE 12	24 VDC	22	IP 65	17	13,2	43	38,6	36	23,5
BOF34220CC	SAE 12	220 VRAC	22	IP 65	17	13,2	43	38,6	36	23,5

For the 220CC coils, a 220V rectifier connector is needed for its correct operation (REF: conledrec220)