

Welding BSP 60° swept with guide

Stainless Steel AISI 316-L

1/1

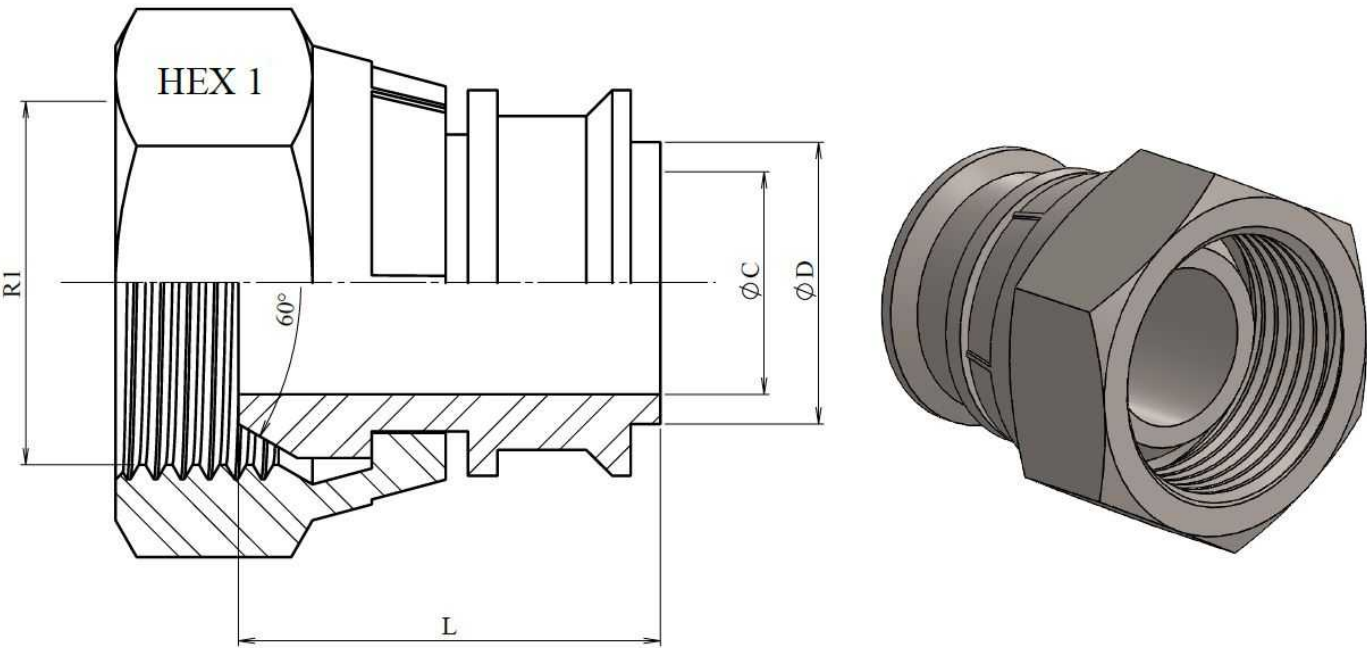

Part nº	DN	R1	L	HEX 1	ØC	ØD
Z128104	1/4"	1/4" BSP	23	19	5	5,8
Z128106	3/8"	3/8" BSP	23,5	22	7	9,8
Z128108	1/2"	1/2" BSP	26	27	9,5	12
Z128112	3/4"	3/4" BSP	28,5	32	15	19
Z128116	1"	1" BSP	33,5	41	22	24,5
Z128120	1"1/4	1"1/4 BSP	38,5	50	26	31
Z128124	1"1/2	1"1/2 BSP	39,5	55	32	39
Z128132	2"	2" BSP	41	70	44	50