

Stainless Steel AISI 316-L

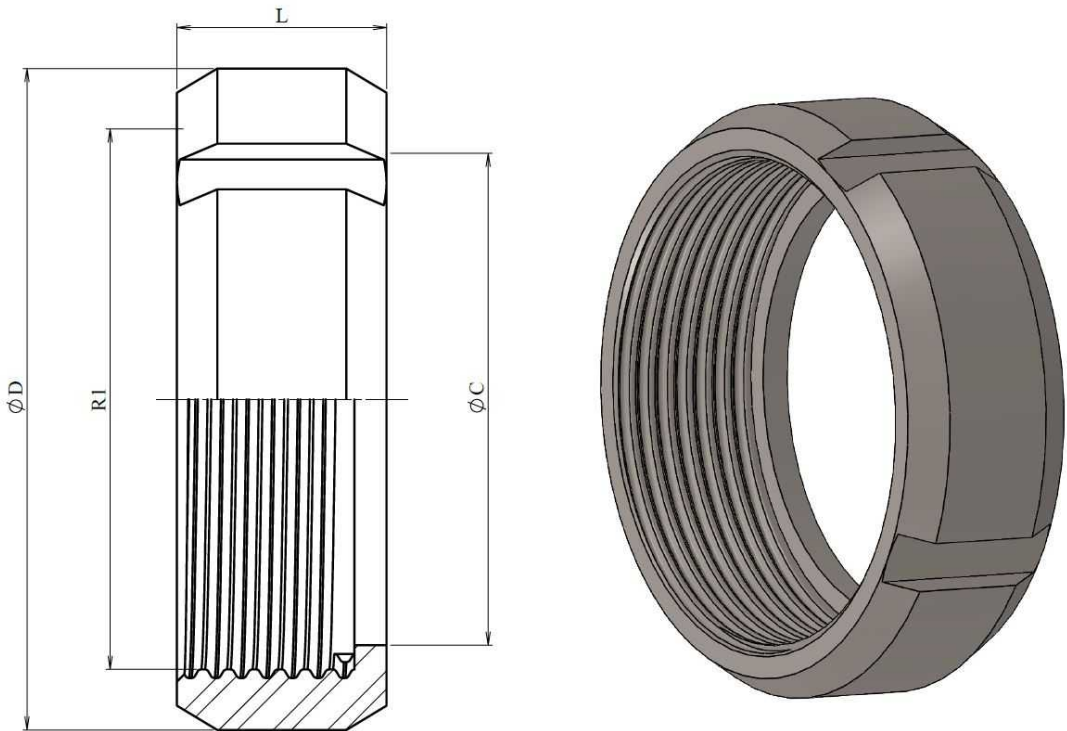

Part nº	DN	R1	ØC	ØD	L
ZMAC H 40	40	M55x3	47	70	25
ZMAC H 50	50	M67x3	57	80	25
ZMAC H 60	60	M79x3,5	67	95	25
ZMAC H 70	70	M90x3,5	77	106	25
ZMAC H 80	80	M102x4	90	118	25
ZMAC H 100	100	M125x4	112	139	26